

**KIT CONTENTS:**

Instructions x 1



Alcohol Wipes x 2



Front Carbon Fiber Side Sill Inserts x 2



Rear Carbon Fiber Side Sill Inserts x 2

**TOOLS REQUIRED:**

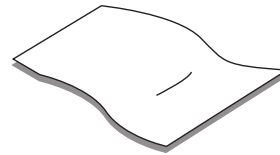

Alcohol Wipes



Cloths for cleaning surfaces

**INSTALLATION PROCESS:**

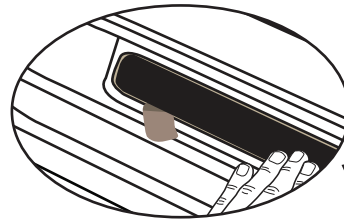
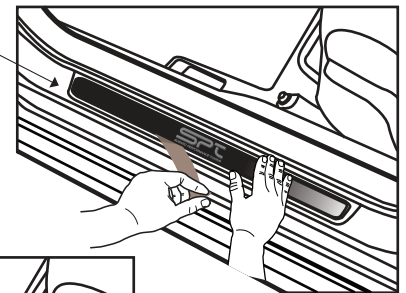
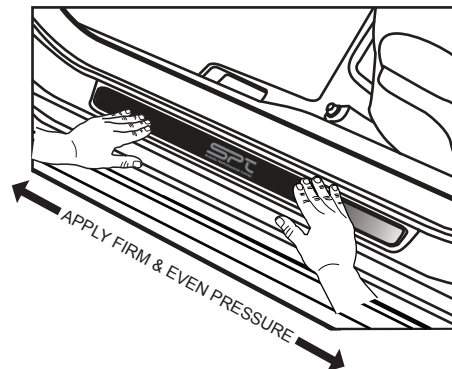
- 1) ALWAYS DRY FIT BEFORE INSTALLATION TO ENSURE PROPER LOCATION AND FIT.
- 2) Recommended temperature range for installation is 16-43 °C (60-110 °F). If temperature is outside of this range, bring car into appropriate environment to achieve proper installation temperature.
- 3) With damp cloth, clean visible dirt, dust or fingerprints from the factory door sill recessed area. Dry with clean dry cloth. Use alcohol wipe to clean factory door sill recessed area once again ensuring removal of all contaminants and allow surface to dry.
- 4) Peel back red tape liner to expose enough adhesive to tack part in place and allow enough liner outside of the part, in order to remove during installation.
- 5) Line up the side sill inserts with even spacing all around with the recessed area as shown in **Fig. A**. Once in position, peel back the remaining tape liner as shown in **Fig. B**.
- 6) Using both hands, apply firm and even pressure (at least 30 psi) across the entire surface of the part for at least 12 seconds, as shown in Fig C. This is critical to ensuring that the part remains on the vehicle.
- 7) Repeat steps for the remaining side sill inserts.

**Fig. A**

**Fig. B**

**Fig. C**