



INSTALLATION INSTRUCTIONS

PART NUMBER: E101SFJ000

DESCRIPTION: Side Sill Plate Kit

KIT CONTENTS:

- Instructions x 1
- Alcohol Wipes x 2
- Sill Plates (4 total)
- Placement Templates



TOOLS REQUIRED:

Cloth for cleaning



INSTALLATION PROCESS:

- 1) There are four templates (one for each door opening). The long pair are for the front door openings, and the short pair are for the rear door openings.
  - 2) Before attaching the templates to the vehicle, thoroughly clean each door sill, and dry with a clean, dry cloth. Use an alcohol wipe to remove any residue.
  - 3) Cut out the templates and place them in the proper car position with tape, as shown in Figure A. Always dry fit before installation to ensure proper location and fit.
  - 4) Required temperature range for installation is 16-43 C (60-110 F) If the temperature is outside of this range, bring car into appropriate environment to achieve proper installation temperature.
  - 5) On the sill plate, peel back a small portion of the tape liner to expose just enough adhesive to tack the part in place, as shown in Figure B. Position the sill plate on the sill next to the appropriate template, to ensure the correct fit, as shown in
- Figure A. The sill plate may need to be tucked under the plastic vehicle trim. Ensure that the edge of the part does not overhang the edge of the door sill. Peel off the rest of the adhesive liner and push down on the part. Repeat for each door opening.
- 6) Press down on the entire surface of the part for 15 seconds at 10 psi. Repeat for all 4 corners.
  - 7) Note: The surface cover mask is to be removed by the retail customer only.

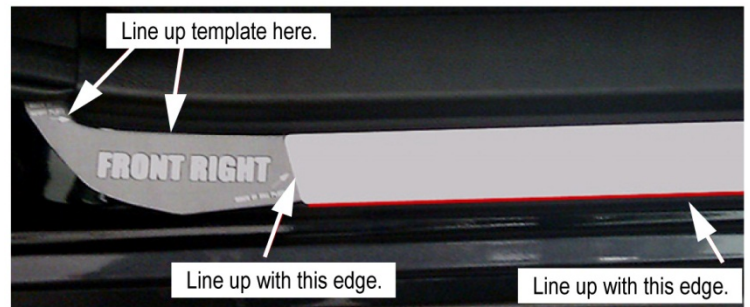
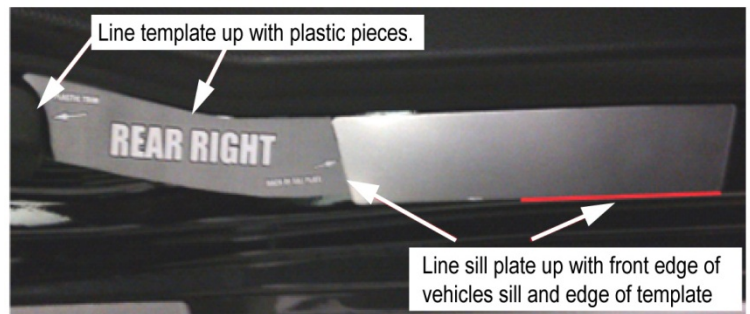

Fig. A



Fig. B

DESCRIPTION Side Sill Plate Kit	ISSUE 00	DATE 03/31/2011	SUBARU OF AMERICA	PAGE 1/1
------------------------------------	----------	--------------------	-------------------	----------